

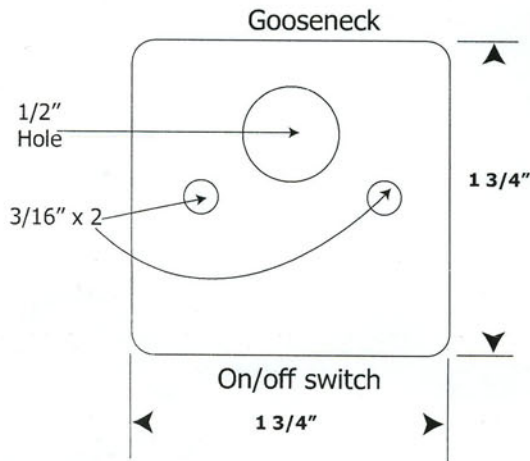

# Model 13.0330 12" LED Map Light



## Mounting template:

Make sure template is to scale, the template should measure 1 3/4" x 1 3/4" (1.75 x 1.75).

Cut out and tape to mounting surface.

Holes: 1.) 1/2" diameter or larger for wire pass through.

2.) 3/16" diameter for screw & nut mounting or appropriate pilot hole if using sheet metal or wood screws.

Your LCR includes two wire connectors for 12 VDC power.

Red is positive 12 V, black or brown is negative 12V (usually ground)

**See wiring diagram for detailed wiring instructions.**

## Using the wire connectors:

One side of the connector has a wire stop in one of the channels. (See Illustration 1). These connectors can be used to splice the LCR to a 12-volt power source or tap into a 12-volt power source.

Before wiring your LCR, turn off power circuit or remove fuse!

## Splicing:

- 1.) Place black or brown (negative) wire from the LCR into the channel with the wire stop. (Ill. #2)
  - 2.) Close the clamp and carefully snap shut with pliers. (Ill. #3)
  - 3.) Place black (or negative) wire from 12-volt power source in the other channel of the connector. (Ill. #2)
  - 4.) Close the clamp and carefully snap shut with pliers. (Ill. #3)
- Repeat steps 1-4 with red/positive wires.

## Tapping:

- 1.) Place black or brown (negative) wire from the LCR into the channel with the wire stop. (Ill. #4)
  - 2.) Close the clamp and carefully snap shut with pliers. (Ill. #5)
  - 3.) Place black (or negative) wire from 12-volt power source in the other channel of the connector. (Ill. #4)
  - 4.) Close the clamp and carefully snap shut with pliers. (Ill. #5)
- Repeat steps 1-4 with red/positive wires.

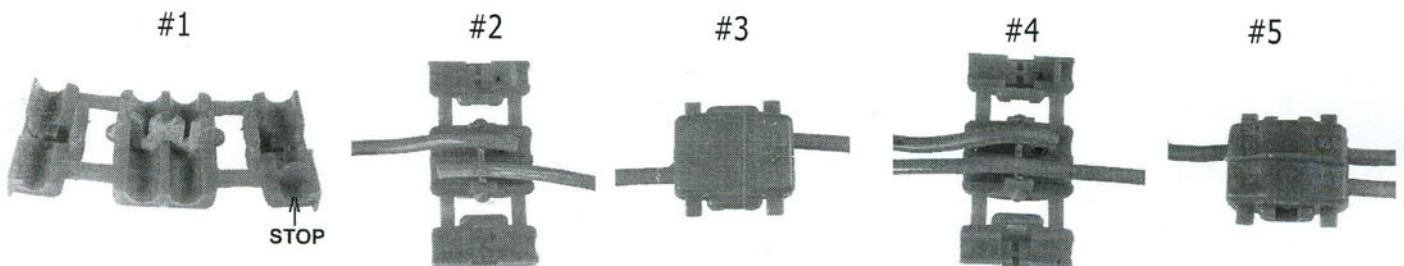

**PRODUCTS COMPANY** • 804 East Hwy. 248 • Cassville, MO 65625  
U.S. and Canada Toll Free Numbers • Phone: 800-641-4098 FAX: 800-526-1240  
E-mail: sales@able2products.com WEB: www.able2products.com