



LIGHT STORM[®]
LED Warning Stick
MODEL NO. 12.6101S

GENERAL INFORMATION

The 12.6101S Light has 10 flash patterns. To change flash pattern, press the momentary switch (Located on the lighter plug adaptor). Each time the momentary switch is pressed, the flash pattern will change. To set Default Random flash pattern **press and hold** momentary switch for more than 5 seconds. The flash patterns are:

- | | |
|-----------------|----------------------|
| 1. 120 FPM | 6. Quad Flash |
| 2. 240 FPM | 7. Double Flash - On |
| 3. 600 FPM | 8. Quad Flash - On |
| 4. 1200 FPM | 9. Fast - Slow |
| 5. Double Flash | 10. Random All |

INSTALLATION INSTRUCTIONS

Use the L - brackets (included) to mount the 12.6101S light. To install mounting bolts to the Warning Stick, remove the 4 screws from the end cap and install the mounting bolts into the desired t-slot as shown in drawing. Re-install the end cap.

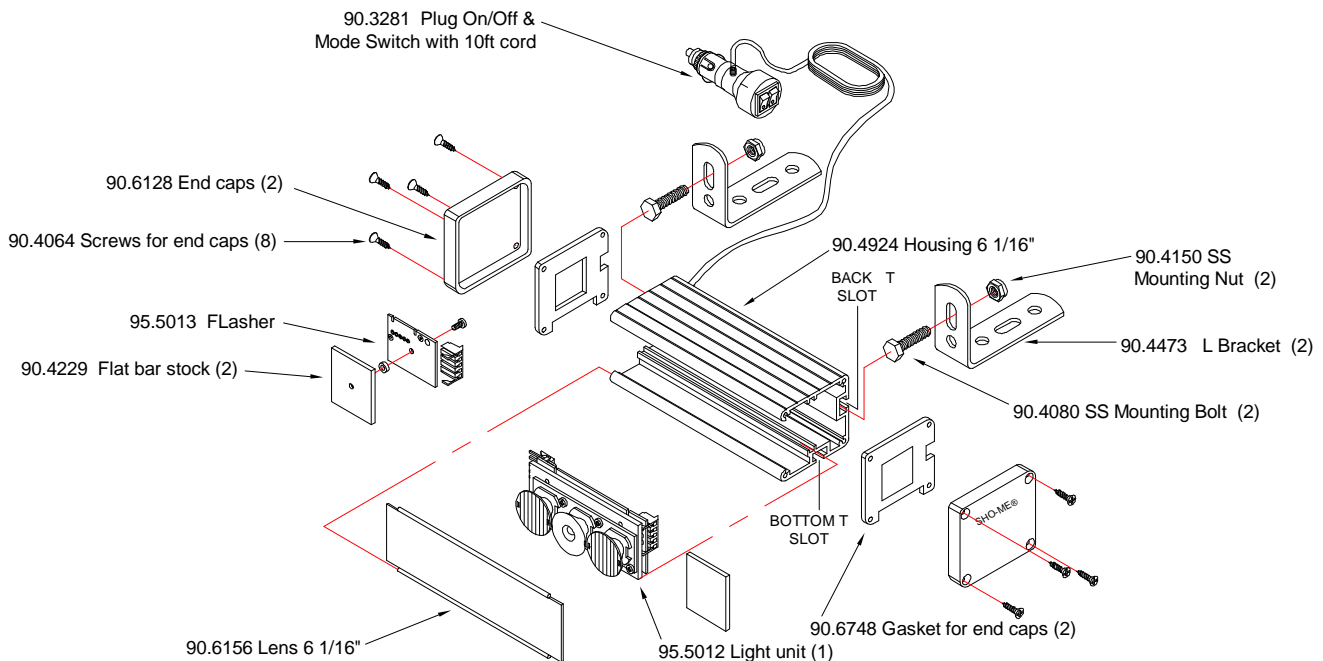

PRODUCTS COMPANY • 804 East Hwy. 248 • Cassville, MO 65625
U.S. and Canada Toll Free Numbers • Phone: 800-641-4098 FAX: 800-526-1240
E-mail: sales@able2products.com WEB: www.able2products.com