



LIGHT STORM[®]
LED Warning Stick
Model 12.6101

GENERAL INFORMATION

The 12.6101 Light has 10 flash patterns. To change flash pattern, momentarily apply +12v to white mode wire. Each time +12v is applied, the flash pattern will change. To set Default Random flash pattern apply +12v to white wire for more than 5 seconds. The flash patterns are:

- | | |
|-----------------|----------------------|
| 1. 120 FPM | 6. Quad Flash |
| 2. 240 FPM | 7. Double Flash - On |
| 3. 600 FPM | 8. Quad Flash - On |
| 4. 1200 FPM | 9. Fast - Slow |
| 5. Double Flash | 10. Random All |

INSTALLATION INSTRUCTIONS

Use the L - brackets (included) to mount the 12.6101 light. To install mounting bolts to the Warning Stick, remove the 4 screws from the end cap and install the mounting bolts into the desired t-slot as shown in drawing. Re-install the end cap.

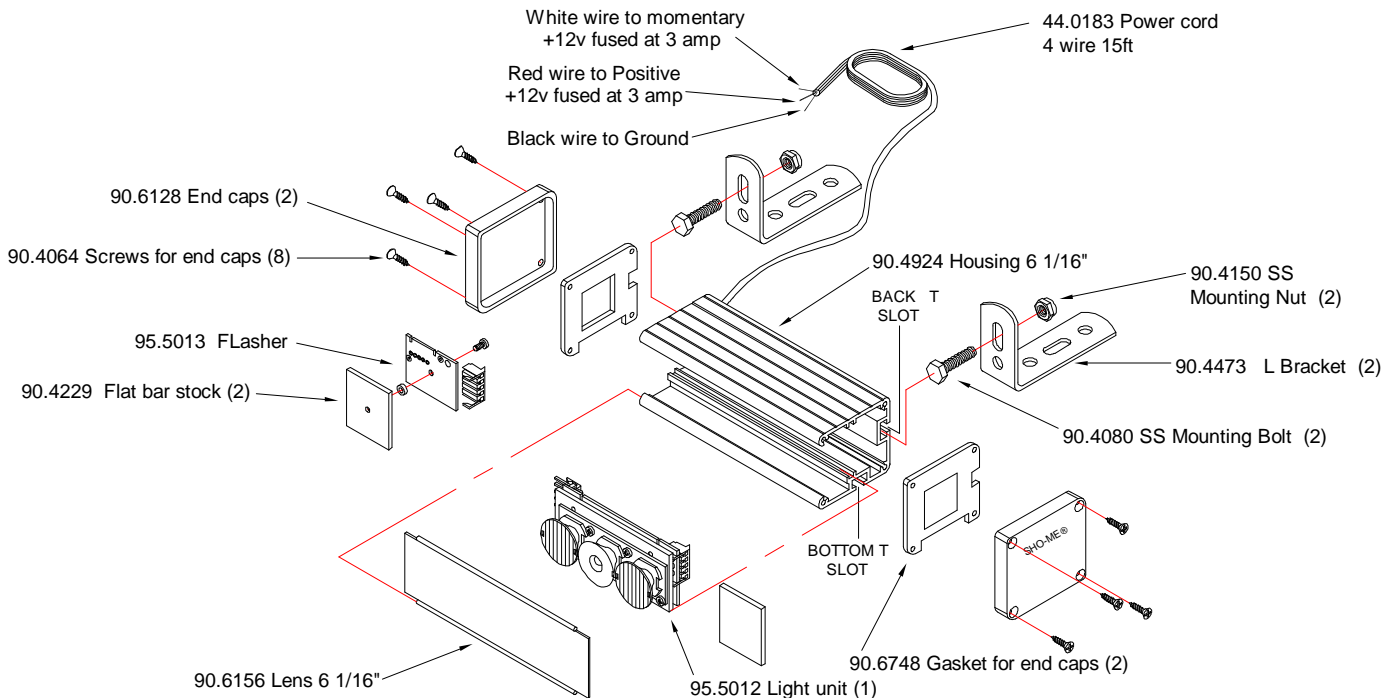

PRODUCTS COMPANY • 804 East Hwy. 248 • Cassville, MO 65625
U.S. and Canada Toll Free Numbers • Phone: 800-641-4098 FAX: 800-526-1240
E-mail: sales@able2products.com WEB: www.able2products.com