

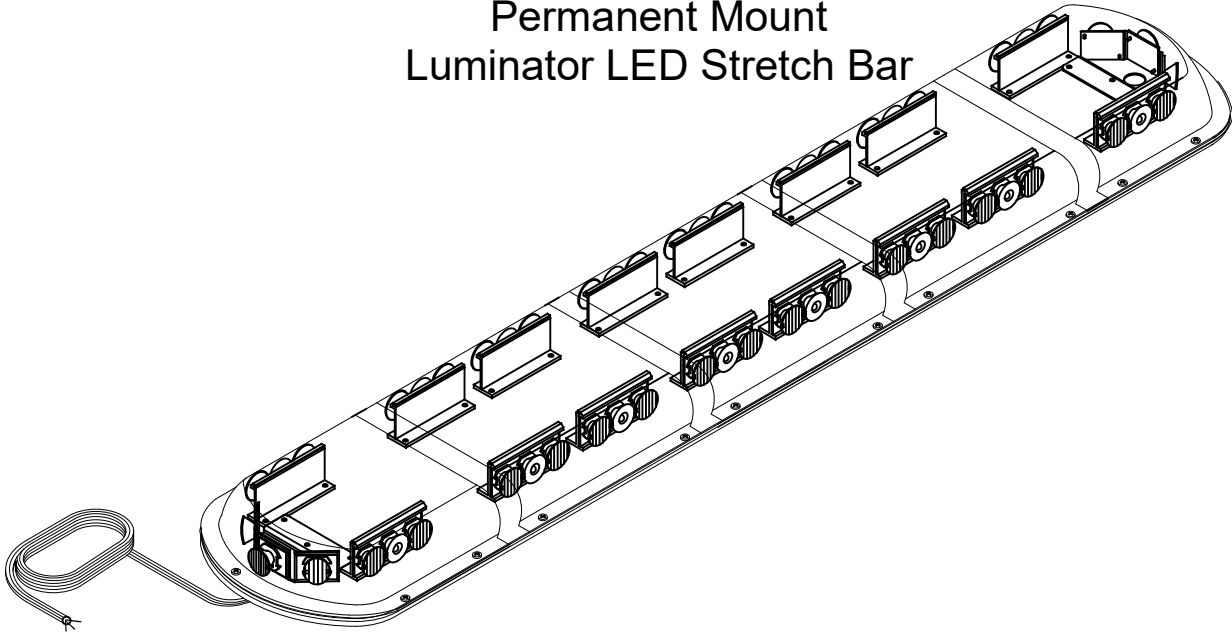

MODEL NO. 12.1247
Permanent Mount
Luminator LED Stretch Bar



GENERAL INFORMATION:

The **SHO-ME** Luminator LED Stretch Bar is equipped with a Solid State Flasher. The flasher has 15 flash patterns including random. To change flash patterns momentarily apply +12v to the white, mode wire. Each time +12v is applied, the flash pattern will change.

FLASH PATTERNS

| | | |
|--------------------|-----------------------|------------------------------------|
| AltQuad | Sequence All & Steady | Double On |
| Single 120 | Single scan 2 | Quad On |
| Single 240 | 25 ms on, 25 ms off | SuperMega then steady |
| Dual Rotate | Beacon Fade | Random All Non Sequential patterns |
| Single Rotate Fast | 90 FPM Alt | Random All Patterns |

INSTALLATION INSTRUCTIONS:

Determine location to mount your Luminator LED Stretch Bar. Attach bolts to bottom of your **SHO-ME** Luminator LED Stretch Bar. Keep in mind airbag deployment area and any other obstacles. Run wire inside of vehicle and connect to switch. A momentary switch is required to change flash patterns.

If mounting this product requires drilling holes, the installer **MUST** be sure that no vehicle components or other vital parts could be damaged by the drilling process. Check both sides of the mounting surface before drilling begins. Also de-burr any holes and remove any metal shards or remnants. Install grommets into all wire passage holes.

Use only soap and water to clean the outer lens. Use of other chemicals could result in premature lens cracking and discoloration. Lenses in this condition have significantly reduced effectiveness. Inspect and operate this product regularly to confirm its proper operation and mounting condition. **Do not use a pressure washer to clean this product.**



PRODUCTS COMPANY • 804 East Hwy. 248 • Cassville, MO 65625
U.S. and Canada Toll Free Numbers • Phone: 800-641-4098 FAX: 800-526-1240
E-mail: sales@able2products.com WEB: www.able2products.com

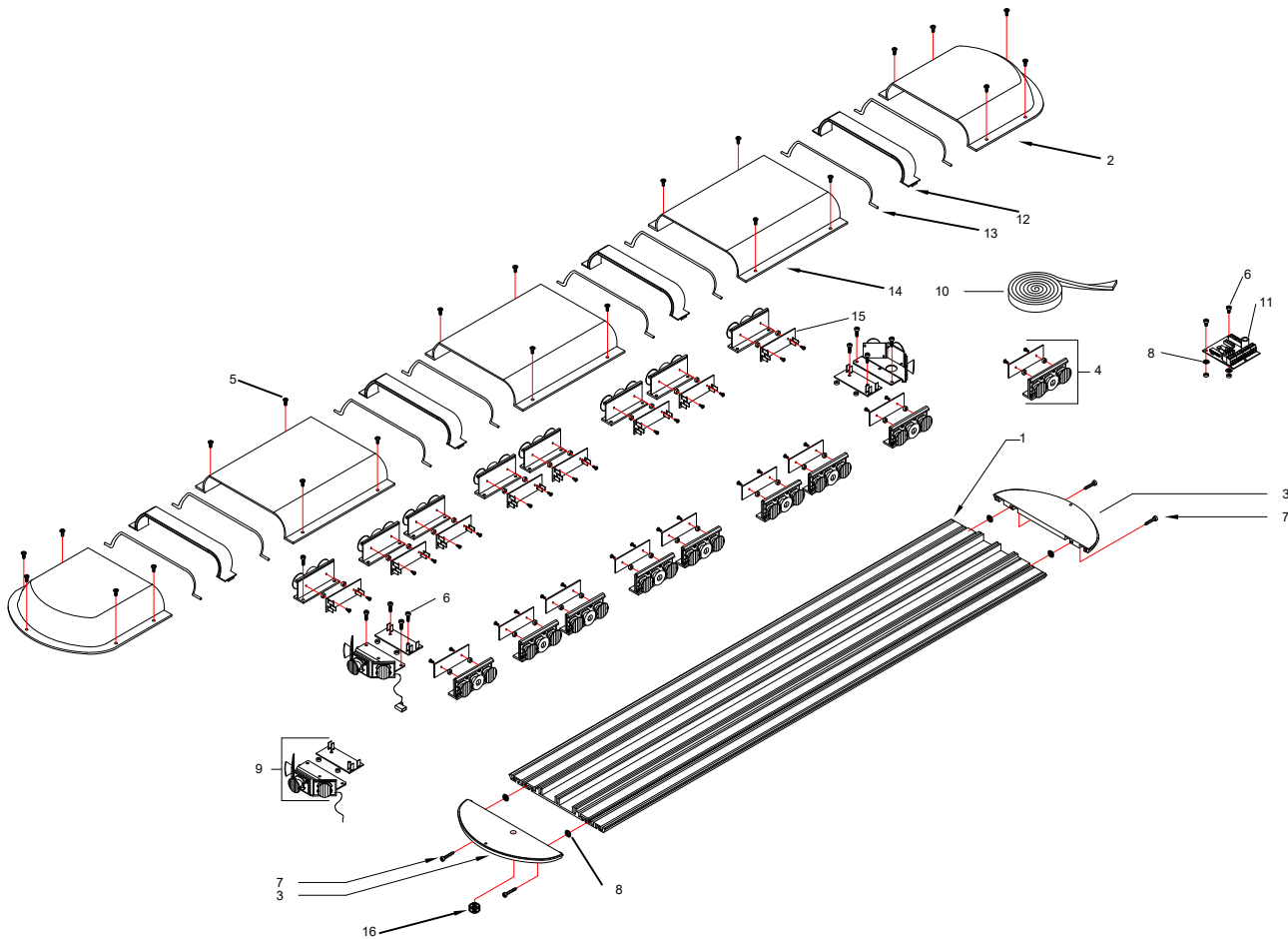

**Parts List for 12.1247
Luminator Stretch Bar
Permanent Mount**

| ITEM | MODEL NO. | DESCRIPTION | QTY |
|------|-------------|--|-----|
| 1 | 90.4986.000 | 41" Long Extrusion | 1 |
| 2 | 90.6137.C00 | Clear Lexan End Cover | 2 |
| 3 | 90.6125.000 | Black Plastic Endcaps | 2 |
| 4 | 12.9530.000 | Luminator (Amber, Blue,Red,White,Green) | 16 |
| 5 | 90.4002.000 | #8 X 1/ 2 812 Self Tapping Screw | 22 |
| 6 | 90.4720.000 | 10mm Screw | 40 |
| 7 | 90.4021.SS | Endcap Self Tapping Screws | 4 |
| 8 | 90.4530.000 | #8 External Tooth Lock washer | 6 |
| 9 | 12.9540.000 | End section Luminator (Amber, Blue, Red, White,Green) | 2 |
| 10 | 90.6039.000 | 1/ 8" X 3/ 4" Black Foam Adhesive 108" | 1 |
| 11 | 95.3728.000 | Luminator Flasher 7 outputs | 1 |
| 12 | 90.6138.000 | Lens Joiner | 4 |
| 13 | 90.6747.000 | Rubber Gasket | 8 |
| 14 | 90.6136.000 | Clear Lexan 10" Middle cover | 3 |
| 15 | 95.5015.000 | Driver | 18 |
| 16 | 90.6432.000 | All fit adjustable bushing | 1 |