

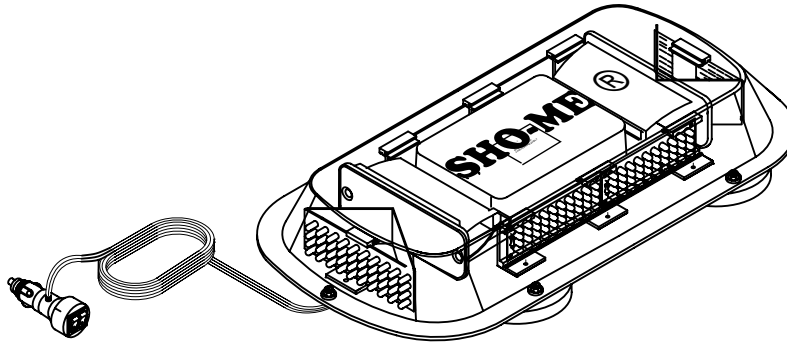

MODEL NO. 11.1230.008  
Magnetic Mount Low Profile  
LED/Strobe Mini Bar



**GENERAL INFORMATION:**

The **SHO-ME**® Low Profile LED/Strobe Mini Bar is equipped with a Solid State LED Flasher & Strobe Power Supply. The flasher has 7 flash patterns including random. To change LED flash pattern, press the momentary switch (**Located on the lighter plug adaptor**). Each time the momentary switch is pressed, the flash pattern will change.

**LED FLASH PATTERNS**

- |                    |                     |
|--------------------|---------------------|
| Double Alternating | Double Simultaneous |
| Quad Alternating   | Quad Simultaneous   |
| Quint Alternating  | Random              |
| Mega Alternating   |                     |

**STROBE FLASH PATTERN**

- Quad Flash

**INSTALLATION INSTRUCTIONS:**

Determine location to mount your Low Profile LED/Strobe Mini Light Bar. Keep in mind airbag deployment area and any other obstacles. Run wire inside of vehicle and connect to cigarette plug, or power outlet.

**WARNING:** The steel content of vehicle roofs varies considerably and some may not be suitable for mounting warning lights with magnetic bases. **It is the sole responsibility of the users** of magnetic based lights to determine if portable warning lights may be safely used on the exterior of their vehicle.

If mounting this product requires drilling holes, the installer **MUST** be sure that no vehicle components or other vital parts could be damaged by the drilling process. Check both sides of the mounting surface before drilling begins. Also deburr any holes and remove any metal shards or remnants. Install grommets into all wire passage holes.

Use only soap and water to clean the outer lens. Use of other chemicals could result in premature lens cracking (crazing) and discoloration. Lenses in this condition have significantly reduced effectiveness. Inspect and operate this product regularly to confirm its proper operation and mounting condition. **Do not use a pressure washer to clean this product.**



**PRODUCTS COMPANY** 804 East Hwy 248 Cassville, MO 65625  
U.S. and Canada Toll Free Numbers Phone: 800-641-4098 FAX: 800-526-1240  
E-mail: sales@able2products.com WEB: www.able2products.com

## Parts List for 11.1230.008 LED/Strobe Mini Bar Portable

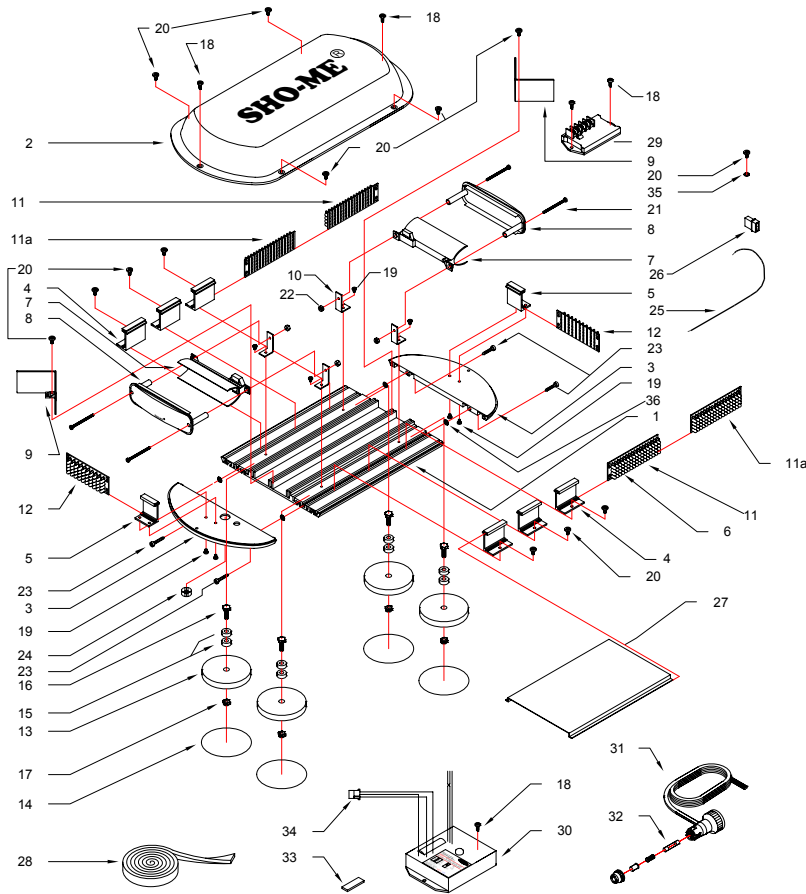

ITEM	MODEL NO.	DESCRIPTION	QTY
1	90.4986.000	Main Alu Extrusion	1
2	90.6127.C00	Clear Lexan Cover	1
3	90.6125.000	Black Plastic Endcaps	2
4	90.6938.000	1 3/ 4" Blk Plastic LED mount	6
5	90.6938.000	1 1/ 4" Blk Plastic LED mount	2
6	90.3930.(R/A)00	Red/Amber LED 30 Degree	-
-	90.3910.B00	Blue LED 30 Degree	352
7	20.1881.SDC	Strobe Housing	2
8	20.1885.C00	Strobe Cover Lens	2
9	11.6123.000	Angled Mirror	2
10	95.4203.000	Strobe Mounting Alu Brackets	4
11	95.3830-1.000	Long LED Board left	2
11a	95.3830-2.000	Long LED Board right	2
12	95.3730.000	Short LED Board (40)	2
13	90.4250.000	3 1/ 4" Do-Nut Magnet	4
14	90.6140.000	3.200 Diameter Vinyl Discs White	4
15	90.6919.000	Spacer .250 X .562 X .250	8
16	90.4490.000	1/ 4 -20 X 3/ 4 Hex Hd Bolt SS	4
17	90.4150.000	1/ 4-20 Nylon Insert L/N NTS SS	4
18	90.4002.000	#8 X 1/ 2 812 Self Tapping Screw	5
19	90.4072.000	1/ 4" #6-32 Phillips	8
20	90.4590.SS	10MM Wide Head Screw	18
21	90.4177.000	Phil Pan Mach Screw 18-8 SS BL	4
22	90.4136.SS	6-32 Nyl Ins Locknut	4
23	90.4021.SS	Endcap Self Tapping Screws	4
24	90.6880.000	Grommet Black Heyco #2077	1
25	41.0181.010	18 GA RVI Wire 15" (specify color)	21
26	90.6729.000	Female Connector	1
27	90.4930.000	Metal Cover	1
28	90.6039.000	1/ 8" X 3/ 4" Blk Foam Adhesive 50"	1
29	11.1005.TSF	Solid State Random LED Flasher	1
30	21.7220.P	2 Outlet Power Supply	1
31	90.3281.000	Cigarette Power and Mode Switch	1
32	76.0005.AGC	5 Amp Fuse	1
33	90.6087.000	3M Double Sided Tape (N" X M")	3
34	90.6728.000	Male Connector	1
35	90.4960.000	Small Lockwasher for Grounds	6
36	90.4530.000	#8 External Tooth Lock Washer	4

### LIMITED WARRANTY

Able 2 Products Company warrants each new product (except bulbs, strobe tubes, strobe power supplies and LED Products) to be free from defects in material and workmanship for a period of two years from the date of purchase. During this warranty period, the obligation of Able 2 is limited to repairing or replacing, as Able 2 may elect, any part or parts, which after examination by Able 2 are determined to be defective, when they are delivered pre-paid. This limited warranty does not cover travel expense, the cost of specialized equipment for gaining access to the product, or labor charges for the removal and re-installation of the product.

Able 2 Products Company shall not be liable for incidental or consequential damages, including but not limited to : Loss of use of vehicle, Rental of substitute vehicle, Loss of time, Loss of work, Inconvenience, Transportation expenses, Telephone, Lodging, Loss of revenue, Loss of and /or damage to personal property for or arising out of breach of any express or implied warranty of its products.

Use of lamp or other electrical load of a wattage higher than installed or recommended by the factory, or use of inappropriate or inadequate wiring or circuit protection causes this limited warranty to become void. Able 2 Products Company will in no way be liable for any loss of profits or any indirect or consequential damages arising out of any such defect in material and workmanship whether loss is due to negligence or breach of warranty. This limited warranty does not apply to shipping damage, accident, alteration, tampering, misuse or abuse and unauthorized service.

This limited warranty is expressly in lieu of all other express or implied warranties, including the implied warranty of merchantability and the implied warranty of fitness for a particular purpose, and of all other obligations or liabilities on the part of Able 2 Products Company. There are no warranties, unless expressed in authorized Able 2 literature, which extend beyond the description of the face hereof. No dealer, distributor, employee, or representative of the company is authorized to change this warranty in any way or to grant any other warranty.

<b>WARRANTIES:</b>	All LED Products . . . . .	5 Years
	T Model & Potted Strobe Power Supplies	2 Years
	All Other Strobe Power Supplies . . . . .	5 Years
	All Other Products EXCEPT Bulbs . . . . .	2 Years (under normal use)
	Strobe Tubes . . . . .	1 Year (under normal use)
	NOTE: Halogen and Incandescent Bulbs are not covered by warranty.	

### PRODUCT RETURNS

If a product must be returned, contact our factory by calling 1-800-641-4098 to obtain a Return Authorization Number (RA) before you ship the product. Write the RA Number clearly on the package and return it to Able 2 Products Company, P.O. Box 543, 804 E. Hwy. 248, Cassville, MO 65625-0543. A packing slip should be included with all shipments listing the sender's name, address, daytime phone number and description of defect. Your product will be put in first-class operating condition or replaced with a new part, and returned pre-paid.